

## Instructions for 2L/ 5L/ Mini Keg with Double Ball Lock Spear, Tap, CO2 Regulator System.

1 x Gasketed-screw-on cap as standard

1 x 2L or 5L Mini keg

1 x Double ball lock spear

1 x Mini commercial 60PSI regulator

1 x DMO premium 304 stainless steel flow control tap.

3 x 16g Threaded CO2 Cartridge/ Capsule.

1 x Tap Shank

1 x Silicone tube

1 x SS Wrench

1 x Regulator Adaptor

1 x Liquid Ball Lock

1 x Gas Ball Lock



## Instructions for 2L/ 5L/ Mini Keg with Double Ball Lock Spear, Tap, CO2 Regulator System.

### PART ONE: Getting Ready.

**Most Important:** Please clean your new DMO Brewing Co mini keg, cap, spear body, faucet and silicone tube with warm water and mild soap and rinse well before use.

Connect the liquid ball lock onto the upright post on the spear and then the gas ball lock onto the angled post. Measure and cut the silicone tube according to keg height and insert firmly onto the bottom of the spear, make sure the tube is long enough to sit comfortably on the bottom of keg.

If the ball locks seem stiff or sticky rub a small amount of food grade lube around the o rings on the spear posts and try connecting again.



\*\*\*\*\* if the silicone tube is too short you won't get the most out of your keg and if the tube is too long, it may crimp inside the keg and cause an unnecessary blockage or kick up to high.

## Instructions for 2L/ 5L/ Mini Keg with Double Ball Lock Spear, Tap, CO2 Regulator System.

Remove the liquid out ball lock and screw the shank onto the thread ensuring it is seated properly and tight.

Remove the gas in ball lock and screw the regulator adaptor onto the thread ensuring it is seated properly and tight.

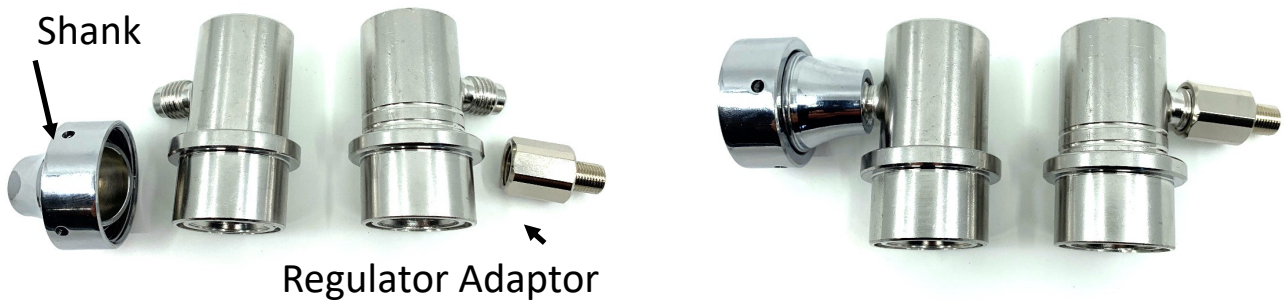

**Important:** If you have not tightened the collar on the shank or the regulator adaptor up enough or not seated the tap correctly it will cause leakage.

Attach the tap to the liquid out ball lock shank. Make sure you have the tap seated correctly and in line with the ball lock. Use the wrench to ensure you have a good seal.

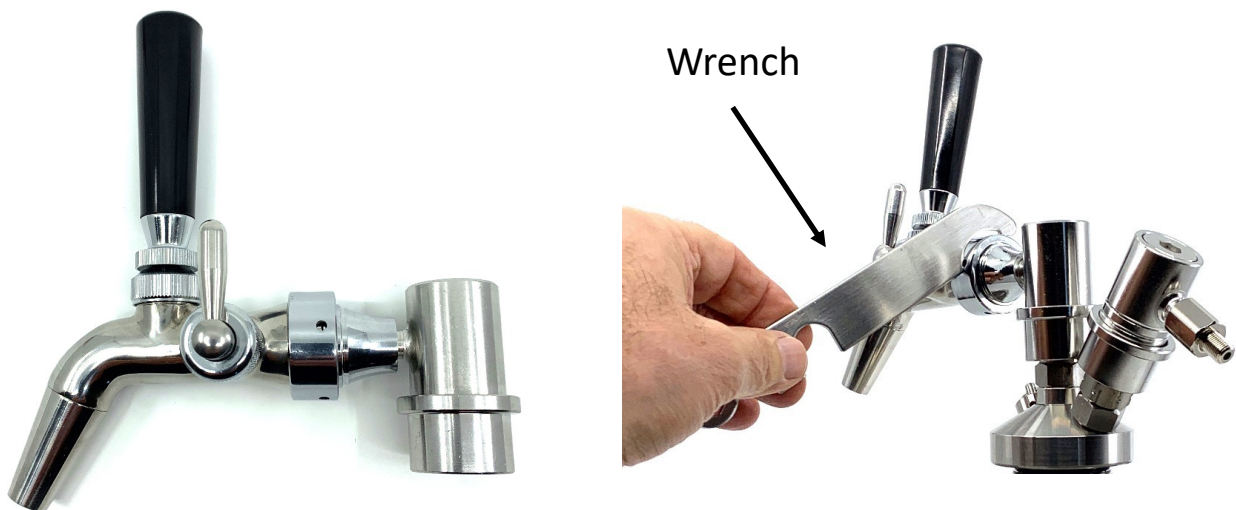

## Instructions for 2L/ 5L/ Mini Keg with Double Ball Lock Spear, Tap, CO2 Regulator System.



**IMPORTANT:** Ensure the regulator knob is in the **OFF** position. If not, please follow the arrow and turn the regulator knob **counterclockwise to the OFF position**.



Turn in a new 16g CO2 Capsule with thread type of 3/8-24UNF, turn clockwise firmly into the regulator base.

**IMPORTANT: DON'T** stop turning if you hear a slight gas leak, finish turning it in all the way, so that it seals properly.

## Instructions for 2L/ 5L/ Mini Keg with Double Ball Lock Spear, Tap, CO2 Regulator System.

### When the time is right

Get your mini keg filled from your favorite Craft Brewery or decant your own home brew and screw the gasketed-screw-on cap back on and up tight to keep your beer fresh and carbonated.

When you are ready unscrew the gasketed-screw-on cap and put it in a safe place. Make sure the silicone tube is attached firmly to the spear, lower the silicone tube into the full mini keg and screw the spear firmly onto keg.



## Instructions for 2L/ 5L/ Mini Keg with Double Ball Lock Spear, Tap, CO2 Regulator System.



### PART TWO: TAPPING.

Connect your tap with the liquid out ball lock to the center upright post on the spear



Attach the regulator to the gas in ball lock adaptor. Make sure you have the regulator seated correctly and ensure you have a good seal. It must still be in the OFF position.



Then reconnect the gas ball lock on the angled post on the spear ensuring that all of the connections remained secure and you can comfortably see the regulator dial and easily access the regulator knob.

## Instructions for 2L/ 5L/ Mini Keg with Double Ball Lock Spear, Tap, CO2 Regulator System.



Pressure relieving ring



Pull on pressure relieving ring for a couple of seconds. If the keg was shaken in transit or warmed, it may contain excessive pressure which must be relieved before tapping. A hissing noise is expected.

Slowly turn the regulator knob in a clockwise direction to 5 PSI, and stop for 2 seconds and then turn off the regulator. Wait for 2 mins, then pull on the pressure relieving ring for a couple of seconds. This is adjusting the internal pressure of keg.

Put a glass or pitcher under the tap spout, then with the tap handle pulled forward (ON), slowly turn the regulator knob on in clockwise direction, until beer starts to flow out.



## Instructions for 2L/ 5L/ Mini Keg with Double Ball Lock Spear, Tap, CO2 Regulator System.

Please don't continue adding unnecessary pressure, we suggest tapping at 5-8 PSI. Your regulator has a max pressure 60PSI, so please stop turning the regulator knob when the pressure is enough that you have beer pouring out of the spout with a perfect foam.

Too much pressure would cause too much foam.

When the beer has stopped or begins to flow slower, try turning the regulator knob on slowly, to increase pressure.

When you finish tapping, please turn regulator knob to **OFF** position.

If no beer is flowing flow out, then the your CO2 capsule needs to be replaced, or unfortunately you have run out of beer. Normally, a 16g capsule can pour 4-5 liters of beer of pre carbonated beer.

**Caution:** Removing a used Co2 bulb from the regulator should be done slowly and with care a small swish sound is expected if some residual pressure remains.

Turn the regulator knob off and install a new capsule into the regulator by following the steps on page 4.





## Some trouble shooting

### Sticking Ball Locks:

Rub a small amount of food grade lube around the o rings on the spear posts.

### Faucet Leakage:

Please unscrew and remove the tap, then reinstall it again, make sure the tap is seated properly and securely matching the grooved connection on the spear and re tighten.

### Too much Foam:

Decrease the pressure by releasing the relieving ring for a couple of seconds. Then read-just your pressure.

### Leakage of CO2:

Check that the CO2 capsule is screwed in properly to the base of the regulator.

In case of a CO2 leakage, please observe the position of leakage and tighten the affected component, but never unscrew if gas remains. Turn the regulator off first.

## WARNING

1. Please keep away from children under 18.
2. Never point your mini keg towards anyone.
3. Do not over heat your mini keg as rupture may occur! Washing it its fine.
4. Discontinue using this equipment if you are unable to solve a leakage issue or visible damage is found.
5. The Co2 bulb threaded end seal is broken when screwed into the regulator base. Un-screwing before it's empty can result in the immediate loss of high pressure gas. Please remember, never unscrew the Co2 capsule before all the gas is used up, liquid Co2 spraying onto unprotected skin may cause serious damage.
6. The exterior of the Co2 bulb may become frozen when in use, this is normal. But don't touch it with bare hands, your fingers could stick to the frozen surface and cause injury.
7. Never take Co2 bulbs when you travel by air.